

# DEPALLETISER

## AUTOMATIC DEPALLETISER



### FEATURES:

- Built in the UK
- Full 304 stainless steel manufacture
- Heavy duty chain system
- Easy operation via HMI
- Range of accessory equipment

**The depalletiser is a fully automated machine for transferring standard, sleek or slim beverage cans from supplier pallets to the canning line. It is fully integrated with the canning line and uses a Siemens S7-1200 PLC for the control system and a Siemens HMI.**

For optimum hygiene, the depalletiser is manufactured from food grade 304 stainless steel. This ensures robustness and a high level of cleanliness, as well as the safe use of cleaning agents. A food grade grease is specified for machine lubrication.

The safety interlock system ensures the operator cannot come into contact with any moving parts of the depalletiser.

Machine design features a belt drive linear actuator for smooth and accurate pushing of the cans and photocell sensors to monitor can build-up. A high torque 3.2 kW motor raises and lowers the pallet with precision movement using a heavy duty chain.

The HMI touch screen allows the operator to easily manage the automatic setting of pallet layer increments and the automated removal of pallet layer pads is also provided.

Optional accessory equipment includes a can twist or lowerator for taking cans to ground level. An ionising air rinser for can sterilisation can be mounted to either of these options. A high level conveyor extension with a walkway gantry is also available, which allows monitoring of the conveyor, along with full layer depalletizing for increased flow of cans.

# DEPALLETISER

## AUTOMATIC DEPALLETISER

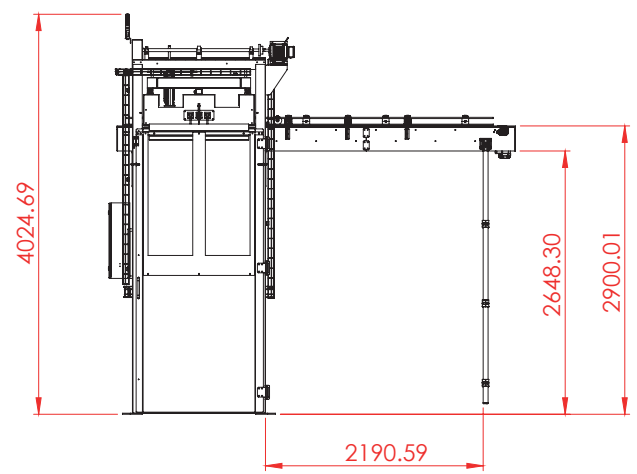
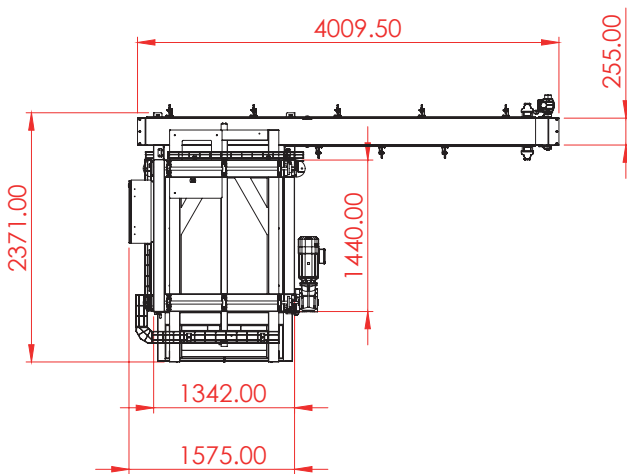

## TECHNICAL DATA

<b>PALLET SIZES</b>	MAXIMUM FOOTPRINT 1420 X 1120 MM MAXIMUM HEIGHT 2850 MM
<b>CAPACITY</b>	6000 CANS PER HOUR
<b>AC MOTOR POWER</b>	400V, 16A, 3.2 KW
<b>FOOTPRINT</b>	2266 X 1865 MM